

Excellent Integrated System Limited

Stocking Distributor

Click to view price, real time Inventory, Delivery & Lifecycle Information:

[Molex Connector Corporation](#)
[0472861001](#)

For any questions, you can email us directly:
sales@integrated-circuit.com

10 9 8 7 6 5 4 3 2 1

F
E
D
C
B
A

F
E
D
C
B
A

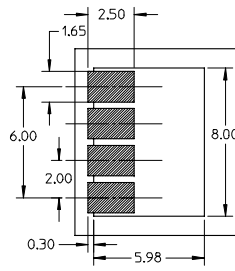
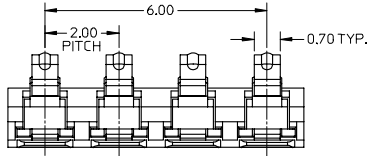
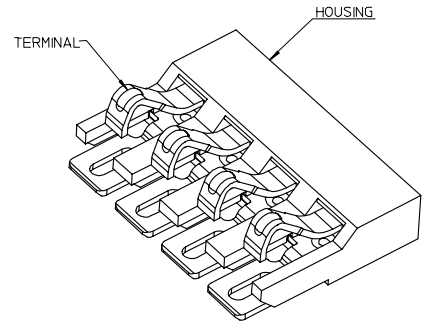
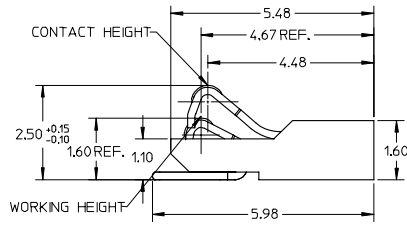
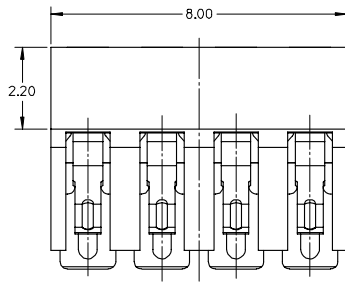

RECOMMENDED PCB LAYOUT
TOLERANCE: +/- 0.05

- NOTE:
- 1.MATERIAL:
HOUSING: HIGH TEMPERATURE THERMOPLASTIC,COLOR:BLACK
TERMINAL: COPPER ALLOY
 - 2.FINISH:
CONTACT AREA: 0.75 MICRON GOLD MIN OVER 1.25 MICRON NICKEL MIN.
SOLDER AREA: GOLD FLASH (0.075~0.125 MICRON) OVER 1.25 MICRON NICKEL MIN.
REST AREA: 1.25 MICRON NICKEL MIN.
 - 3.COPLANARITY: 0.1 MAX AMONG THESE SOLDER TAILS.
 - 4.PRODUCT SPECIFICATION: PS-47286-001
 - 5.RECOMMENDED WORKING DEFLECTION RANGE:0.6-1.00 MM

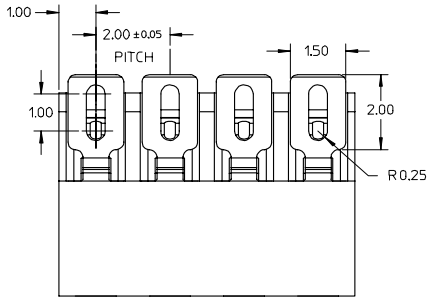

REVISE	EC NO:	2004/09/08	QUALITY SYMBOLS	GENERAL TOLERANCES (UNLESS SPECIFIED)		DIMENSION STYLE		SCALE	DESIGN UNITS	THIRD ANGLE PROJECTION
	DRW:	BRUNELSHEN		mm	INCH	MM ONLY	5:1	METRIC		
	CHKD:	XU		4 PLACES	± ---	± ---	DRAWN BY	DATE	TITLE	
	APP:	JICHEN		3 PLACES	± ---	± ---	SSUN	2005/07/29	2.0MM PITCH 4 CIRCUITS 0.7MM CONTACT WIDTH BATTERY CONNECTOR	
			2 PLACES	± 0.15	± ---	CHECKED BY	DATE			
			1 PLACE	± 0.20	± ---	XUXIANG	2006/07/06			
			ANGULAR ± 2 °			APPROVED BY	DATE			
			DRAFT WHERE APPLICABLE MUST REMAIN WITHIN DIMENSIONS			JENNY CHEN	2006/07/07			
						MATERIAL NO.	DOCUMENT NO.			
						472861001	SD-47286-001			
						THIS DRAWING CONTAINS INFORMATION THAT IS PROPRIETARY TO MOLEX INCORPORATED AND SHOULD NOT BE USED WITHOUT WRITTEN PERMISSION		SHEET NO.		
								1 OF 1		

9 8 7 6 5 4 3 2 1