

Excellent Integrated System Limited

Stocking Distributor

Click to view price, real time Inventory, Delivery & Lifecycle Information:

[Hammond Manufacturing](#)
[2D1K12](#)

For any questions, you can email us directly:

sales@integrated-circuit.com



Quality Products. Service Excellence.

DIN Rails *DR Series*



- Field installable.
- Includes a set of 3 plated rails.
- Available in 3 industry standard profiles - DIN 1, DIN 3, and CENELEC.
- DIN rail mounting kit required for installation.
- Rails have a 0.28 x 1.25 oblong slot on each end.
- Zinc plated.

Accessories

- DIN Rail Mounting Kit

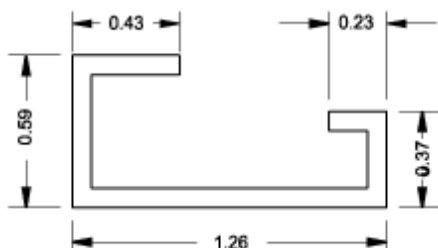

Asymmetric DIN 1 Pro

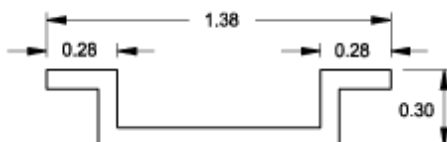

Symmetric DIN 3 Pro

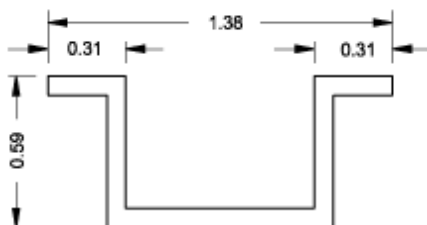

CENELEC Pro

AsymmetricDIN 1 Profile	Symmetric DIN 3 Profile	Cenelec Profile	Length
Part No.	Part No.	Part No.	
2D1K12	2D2K12	2DCK12	9.25
2D1K16	2D2K16	2DCK16	13.25
2D1K20	2D2K20	2DCK20	17.25
2D1K24	2D2K24	2DCK24	21.25

AsymmetricDIN 1 Profile	Symmetric DIN 3 Profile	Cenelec Profile	
Part No.	Part No.	Part No.	Length
2D1K30	2D2K30	2DCK30	27.25

Data subject to change without notice